

Cell 100 Series

- designed for tubes 32 mm (1 ¼")
- supplied with M6 closing bolt
- mounting hole suitable for up to 6,5 mm (¼") bolt

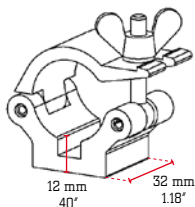

- made from ultra high tensile aluminium alloy
- professional micropercussion marking
- highly polished surface
- anodized versions available on special request



Ø 32 mm
1 ¼"

CELL 101 CLAMP BASIC

SWL	Weight	
100 Kg	0,15 Kg	basic Clamp can be used for welding or construction of special items
220 lbs	0.33 lbs	

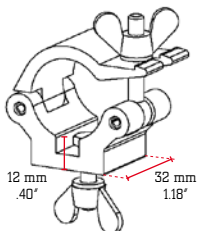

Ø 32 mm
1 ¼"

CELL 102 CLAMP WITH BOLT AND WINGNUT

SWL	Weight	
100 Kg	0,25 Kg	clamp supplied with M6 x 25 bolt and wingnut
220 lbs	0.55 lbs	

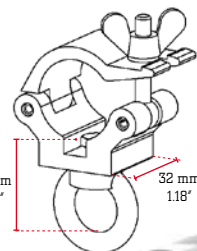

Ø 32 mm
1 ¼"

CELL 103 CLAMP WITH LIFTING EYE

SWL	Weight	
100 Kg	0,70 Kg	clamp supplied with steel eye for rope or cable attachment
220 lbs	1.54 lbs	

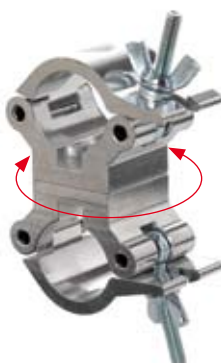
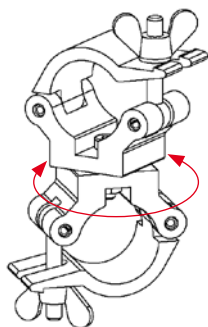

Ø 32 mm
1 ¼"

CELL 104 SWIVEL COUPLER

SWL	Weight	
100 Kg	0,80 Kg	set of two clamps free to rotate 360° for connection two tubes
220 lbs	1.76 lbs	

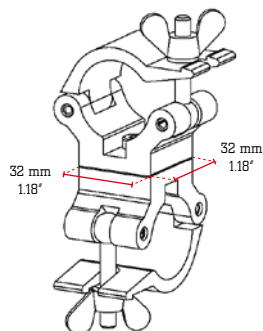

Ø 32 mm
1 ¼"

CELL 105 90° FIXED COUPLER

SWL	Weight	
100 Kg	0,80 Kg	set of two clamps fixed at 90° to each other for connection of two tubes
220 lbs	1.76 lbs	

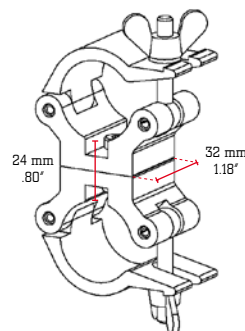

Ø 32 mm
1 ¼"

CELL 106 PARALLEL COUPLER

SWL	Weight	
100 Kg	0,80 Kg	set of two clamps fixed parallel to each other for connection of two tubes
220 lbs	1.76 lbs	

CELL 113 HORIZONTAL ATTACHMENT

L1	L2	L3	
250 mm	500 mm	750 mm	32 x 1,5 mm also available in custom lengths.
9.84'	19.69'	29.53'	

Ø 32 mm
1 ¼"

