

Cell 200 Series

Cell 200 Series

- designed for tubes 48 - 51 mm (1 7/8" - 2")
- supplied with M12 closing bolt
- mounting hole suitable for up to 13 mm (1/2") bolt



- made from ultra high tensile aluminium alloy
- professional micropercussion marking
- highly polished surface
- anodized versions available on special request

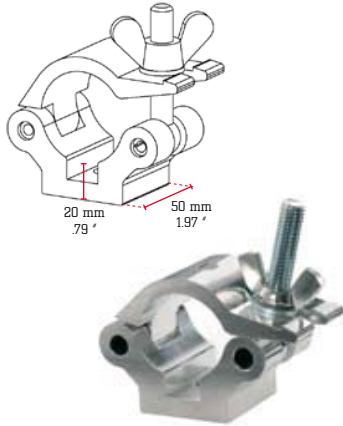

Ø 48-51 mm
1 7/8"-2"

CELL 201 CLAMP BASIC

SWL	Weight	basic Clamp can be used for welding or construction of special items
500 Kg	0,50 Kg	
1102 lbs	1.10 lbs	

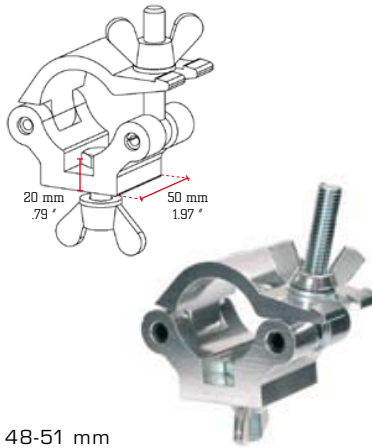

Ø 48-51 mm
1 7/8"-2"

CELL 202 CLAMP WITH BOLT AND WINGNUT

SWL	Weight	clamp supplied with M12 x 35 bolt and wingnut
500 Kg	0,59 Kg	
1102 lbs	1.30 lbs	

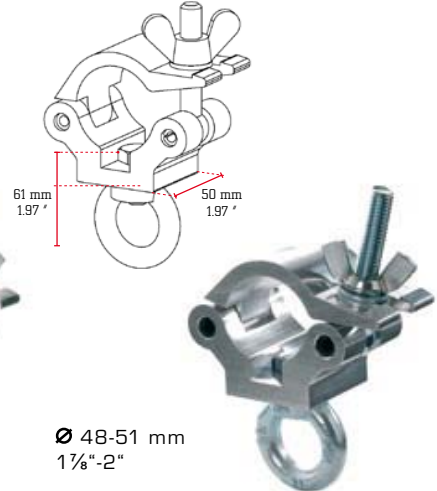

Ø 48-51 mm
1 7/8"-2"

CELL 203 CLAMP WITH LIFTING EYE

SWL	Weight	clamp supplied with steel eye for rope or cable attachment
300 Kg	0,65 Kg	
661 lbs	1.43 lbs	

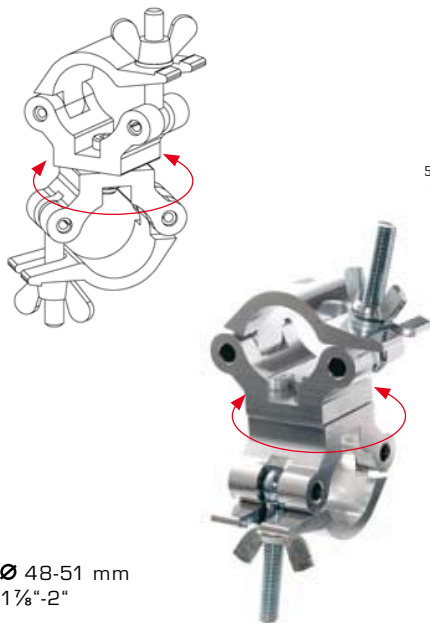

Ø 48-51 mm
1 7/8"-2"

CELL 204 SWIVEL COUPLER

SWL	Weight	set of two clamps free to rotate 360° for connection two tubes
500 Kg	1,00 Kg	
1102 lbs	2.20 lbs	

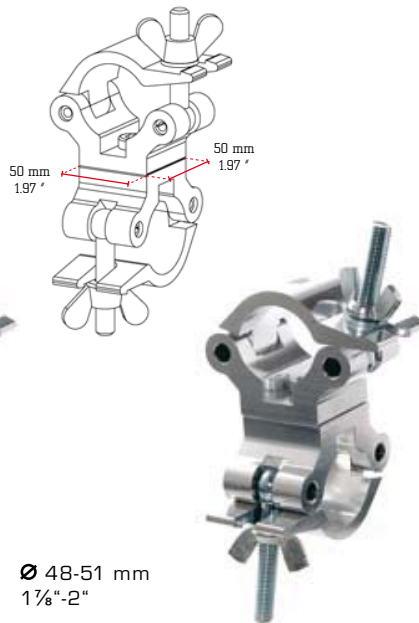

Ø 48-51 mm
1 7/8"-2"

CELL 205 90° FIXED COUPLER

SWL	Weight	set of two clamps fixed at 90° to each other for connection of two tubes
500 Kg	1,00 Kg	
1102 lbs	2.20 lbs	

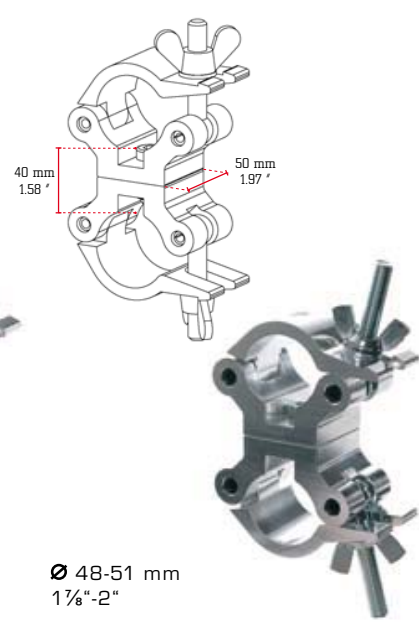

Ø 48-51 mm
1 7/8"-2"

CELL 206 PARALLEL COUPLER

SWL	Weight	set of two clamps fixed parallel to each other for connection of two tubes
500 Kg	1,00 Kg	
1102 lbs	2.20 lbs	

CELL 213 HORIZONTAL ATTACHMENT

L1	L2	L3	50 x 2 mm also available in custom lengths
250 mm	500 mm	750 mm	
9.84'	19.69'	29.53'	

Ø 48-51 mm
1 7/8"-2"



Cell 200 Series

Cell 200 Series

- designed for tubes 48 - 51 mm (1 7/8" - 2")
- supplied with M12 closing bolt
- mounting hole suitable for up to 13 mm (1/2") bolt



- made from ultra high tensile aluminium alloy
- professional micropercussion marking
- highly polished surface
- anodized versions available on special request

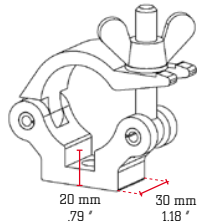

Ø 48-51 mm
1 7/8"-2"

CELL 207

SLIM CLAMP BASIC

SWL	Weight	Notes
300 Kg	0,30 Kg	slim basic clamp can be used for welding or construction of special items
661 lbs	0.66 lbs	

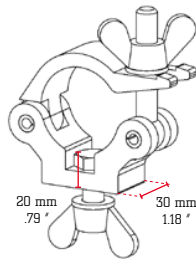

Ø 48-51 mm
1 7/8"-2"

CELL 208

SLIM CLAMP WITH BOLT + NUT

SWL	Weight	Notes
300 Kg	0,39 Kg	slim clamp supplied with M12 x 50 bolt and wingnut
661 lbs	0.86 lbs	

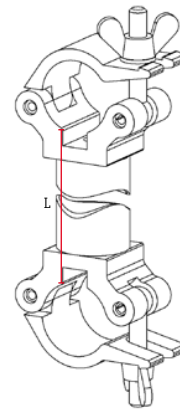

Ø 48-51 mm
1 7/8"-2"

CELL 209

EXTENDED PARALLEL COUPLER

L1	L2	L3	Notes
250 mm	500 mm	1000 mm	set of two clamps connected with aluminum tube in various lengths for parallel tube connections • custom lengths available
9.84"	19.69"	39.37"	

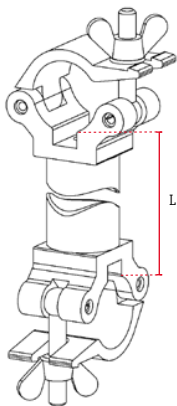

Ø 48-51 mm
1 7/8"-2"

CELL 210

EXTENDED 90° FIXED COUPLER

L1	L2	L3	Notes
250 mm	500 mm	1000 mm	set of two clamps connected with aluminum tube in various lengths for 90° tube connections • custom lengths available
9.84"	19.69"	39.37"	

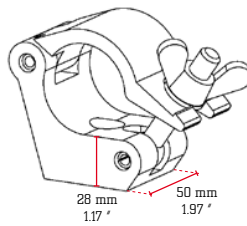

Ø 48-51 mm
1 7/8"-2"

CELL 211

SIDE CLAMP

SWL	Weight	Notes
500 Kg	0,55 Kg	side clamp is ideal for using with trusses • substitute for claw clamp
1102 lbs	1.21 lbs	

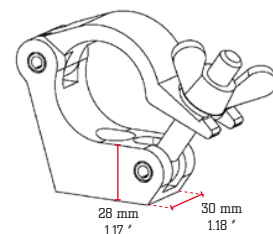

Ø 48-51 mm
1 7/8"-2"

CELL 212

SLIM SIDE CLAMP

SWL	Weight	Notes
300 Kg	0,35 Kg	side clamp is ideal for using with trusses • substitute for claw clamp
661 lbs	0.77 lbs	